

YAMUNA DENSONS Aluminium Ferrules / Inline Connectors for XLPE Cable (Crimping type)



Dimensions of Aluminium Ferrules / Inline Connectors for XLPE Cables

Size mm ²	(ϕ)A ± 0.3	(ϕ)C ± 0.3	J ± 3
25	7.2	9.6	82
35	8.3	11.1	90
50	10.1	13.5	100
70	10.2	14.5	104
95	12.0	16.9	108
120	13.7	19.0	112
150	15.1	21.2	116
185	16.6	23.9	128
225	18.6	26.1	136
240	19.3	27.2	148
300	21.8	30.2	160
400	25.0	34.8	182
500	28.2	39.1	190
630	31.7	44.4	200
800	35.7	49.5	225
1000	41.0	56.0	250

(all dimensions are in mm)

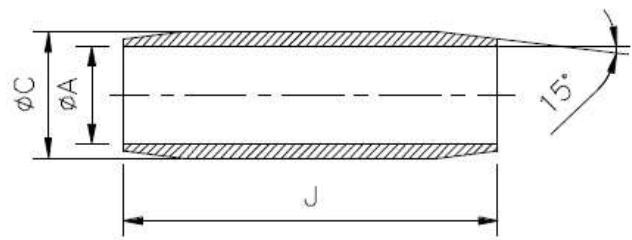

Features :

- Electrolytic grade
- Conductivity 61% (IACS)